



R4720450

📍 Benahavís

REF# R4720450 8.900.000 €

BEDS

6

BATHS

14

BUILT

1021 m²

PLOT

5719 m²

TERRACE

523 m²

Entering this ubiquitous residence creates waves of emotion - peace, tranquility and a feeling of being at one with nature. Villa Calma languishes across a colossal plot of almost 6000m², which itself is nestled safely within one of the finest address in Benahavis - the prestigious Marbella Club Golf Resort. Engineered to reside on one level, this seemingly limitless home stands at 1021m² and offers some of the purest and unparalleled south facing views, stretching down across the green valleys and out over the Mediterranean Sea, to include the mountainous shadow of Gibraltar. The entry to the property gives a glimpse of what lies within as towering entrance windows reach high above, allowing swathes of natural light to flood in. Surrounded by immaculately trimmed lawns and gardens a carport offers guest parking, ensuring privacy and security for those invited in. Once inside, the glass enclosed hallway pulls your gaze upwards to the far reaching ceilings, and over exquisite artwork adorning the walls. A chic sofa offers guests the first chance to take a seat to admire the views of the central atrium, connecting each part of the property. These immense glass walls illuminate inside and elevate the sense of freedom and well being. Throughout the interior gardens walkways allow guests the opportunity of strolling around the property in quiet contemplation of the peace and serenity that lies therein. Shallow water features glisten and reflect light on all sides, and orange trees dotted around offer the citrus aroma so reminiscent of Spanish summer days. The residence offers 6

+34 951 123 083 | +44 (0)330 179 8687 | info@idiliqestates.com Local 28, Edificio D, Centro de Negocios Puerta de Banús, N-340, Km 175, 29660 Nueva Andlucia

IDILIQ

ESTATES

double bedrooms all with resplendent ensuite bathrooms. Each bedroom reveals immense terrace doors that offer direct access to the private gardens, out onto a sleek terrace that surrounds the property. All have either walk in closets or fully fitted wardrobes with copious amounts of storage space. Every bedroom has been custom designed and decorated with an astute mix of golden tones, neutral palettes and crisp whites. Some of the bedrooms feature expansive single beds, others majestic doubles, but all of these private spaces offer corners in which to recline and take a moment of solitude. The ensuite bathrooms are all encompassing and offer stylish bathtubs or walk in rain showers. Moving along wooden floored hallways, the deluxe kitchen faces the rear terrace and overlooks the gardens, out across those views that take centre stage. Bedecked in white neutrals and interspersed with mahogany wood and dark marble, the overall effect is one of space, openness and comfort. Eclectic mixes of 60's artwork feature, modern appliances abound and a living wall creates a touch of freshness. The island unit is sleek and adjacent to the informal breakfast table, in front of an elegant gas fire that offers warmth in the winter to both the kitchen and the living room on the other side. The open plan living room is traditional and elegant with classic wooden moldings emphasizing walls and open access to the terraces outside. The oak wood dining table is majestic and offers a captivating corner in which to dine whilst being entertained by the tinkling of the ivory on the nearby piano. On the other side huge glass terrace doors slide back to allow freedom out into the inner gardens, letting guests revel in summer nights, the gentle sound of the water features lightly in the background. The main terrace plays host to a dining area that enjoys service from the barbecue whilst overlooking the pool below. The pool is a lengthy sleek affair, watched over by a strategically placed Buddha, and offers assuagement from the heat of the day with its sparkling waters. At one end of the swimming pool, and openly constructed, is a sublime lounging area. Showing off flashes of the vast views at every turn, this chill out zone offers residents the chance to recline, take a cocktail and watch the sunsets from the comfort of this alfresco corner of the world. The property has some of the finest luxuries hidden within, including an indoor pool and lounge area, a glass fronted sauna and spa, a fully equipped gym, jacuzzi, a private cinema, a mini tennis court and a laundry room. In the basement there is storage, the machinery rooms, a service toilet and staff quarters. Adjacent is a private garage for up to 7 vehicles. The property has integrated systems that include a home automation system, alarm system with surveillance cameras, a central vacuum cleaning system, surround sound and central heating. This is not just any residence. This property is, quite frankly, unique and utterly sublime. It sits atop the hills, as a king would his throne, overseeing the lands that circumvent its perimeter. With views that are unbeatable, every corner of this property allows light and air in through its glass facades creating an overwhelming sense of composure..... a quietness that takes over the mind, body and spirit. Living up to its name, this is Villa Calma.

IDILIQ

ESTATES



IDILIQ

ESTATES



IDILIQ

ESTATES

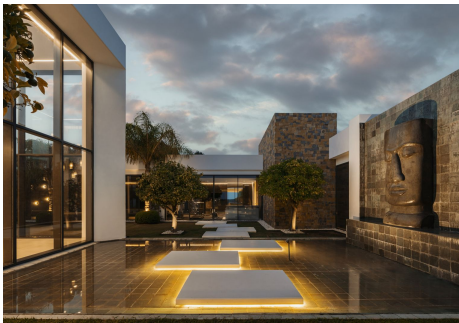

IDILIQ

ESTATES

