



R4654414

📍 Sotogrande

REF# R4654414 4.000.000 €

BEDS

5

BATHS

6

BUILT

838 m²

PLOT

2872 m²

TERRACE

200 m²

Spectacular Villa with modern architecture and unique design. The Villa has been desing to enjoy tthe best views in a unique environment full of beautiful pine forests. Open views to the sea and the Almenara golf course. Located in a cul-de-sac street near to the Almenara Hotel in Sotogrande, Golf Courses and the International School. Minutes from the Port of Sotogrande and La Reserva Country Club.

IDILIQ

ESTATES

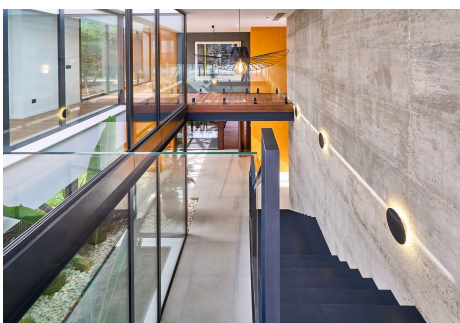

IDILIQ

ESTATES

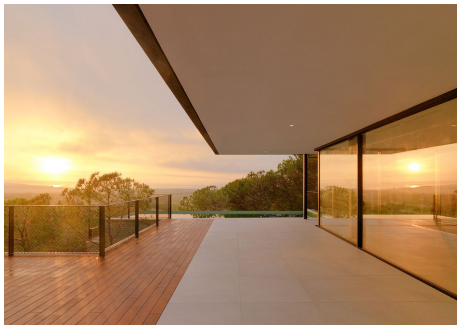

IDILIQ

ESTATES

