

# IDILIQ

ESTATES

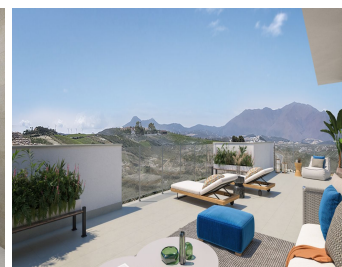
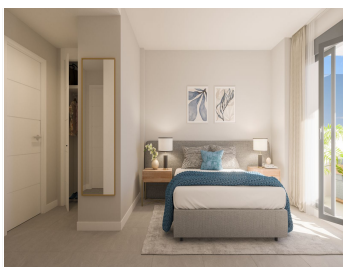

R4451011

📍 Manilva

REF# R4451011 251.000 €

BEDS

2

BATHS

2

BUILT

102 m<sup>2</sup>

TERRACE

14 m<sup>2</sup>

This innovative real estate project consists of 60 multi-family dwellings, offering 2 and 3-bedroom apartments, all equipped with garage and storage room in the basement. The blocks are distributed in first floor, 2 floors and attic, ensuring a variety of housing typologies to suit your needs. The location is ideal, with a privileged connection to the main roads that facilitate your movements along the Costa del Sol and Campo de Gibraltar. In addition, you are surrounded by a complete entertainment environment, with the La Duquesa Marina in the immediate surroundings, a restaurant area to enjoy local and international gastronomy as it is a meeting point for international tourism and a prestigious golf course in the first line that will delight lovers of this sport. Each home stands out for its spacious terraces, providing outdoor spaces ideal for relaxing and enjoying the panoramic views of the golf course that will give you a sense of serenity and wellbeing. The common areas of the project are designed to provide comfort and luxury, with landscaped areas that will allow you to connect with nature, a swimming pool with a relaxing beach of sun loungers and a gastroteca that will become the perfect place to socialize and enjoy special moments. This is a place where comfort and quality of life come together to create an exceptional atmosphere.

+34 951 123 083 | +44 (0)330 179 8687 | [info@idiliqestates.com](mailto:info@idiliqestates.com) Local 28, Edificio D, Centro de Negocios Puerta de Banús, N-340, Km 175, 29660 Nueva Andlucia

# IDILIQ

ESTATES

